

Sport 1000

HAND-HELD LABEL PRINTER



User's Guide

HellermannTyton

TABLE OF CONTENTS

1. INTRODUCTION	1
Welcome	1
Safety Precautions	1
Device Specifications	2
2. GETTING STARTED	3
Unpacking & Inspection	3
Equipment Checklist	3
3. The BATTERY	4
Charging the Battery	4
Inserting the Battery	4
Removing the Battery	5
Using the Battery	5
4. LOADING PRINTER SUPPLIES	6
Installing the Ribbon Cartridge	6
Loading the Supply Spindle	7
Installing the Supply Spindle in the Printer	9
5. The PRINTER INTERFACE	11
6. MAKING LABELS	12
Keys	12
Soft Keys	12
Keypad	12
Screens	13
Edit Screen	13
Edit Screen Guide	14
Size Screen	15
Image Screen	16
Preview Screen	16
Save Screen	17
Text/Image Auto-Size	17
Cells	18
Cells As Seen On the Edit Screen	18
Cells As Seen On the Size Screen	20
Changing Text/Image Size Manually	20
Modifying Text Style Attributes	21
Bold, Italics, and Underline	21
Uppercase and Lowercase	21
Line Justification	22
Applying Graphic Images to Labels	22
The Image Library	23
Creating Barcodes	25
Adding a Border	25

TABLE OF CONTENTS cont.

Previewing & Printing Labels	26
Deleting Current Labels	26
Saving Labels	26
Deleting Saved Labels	27
Opening Saved Labels	28
7. PRINTER SYSTEM SETTINGS	29
Optimizing Performance & Quality	29
DISP (Display)	29
PRINT	30
Heat	30
Motor	31
Feed	31
TEST	32
Feed	32
Test	32
Print Ver	33
RESET	33
HARD RESET	33
8. EXAMPLE LABELS	34
Example Label Directions #1: Pipe Marker	34
Example Label Directions #2: OSHA Safety Label	36
Example Label Directions #4: Barcode	40
9. CLEANING & MAINTENANCE	43
Cleaning Exterior Surfaces	43
Cleaning the Print Head	43
Cleaning the Platen Roller	44
10. COMPLIANCE & WARRANTY	45
FCC Notice	45
Warranty	45
Thermal Print Head	45
Warranty Service Procedures	45
General Warranty Provisions	46
Limitation of Liability	46
11. TROUBLESHOOTING TIPS	48
Symptoms & Solutions	48
Error Messages/Meaning	50
12. SOFT KEY MENU SYSTEM	51
13. ACCESSORIES & SUPPLIES	53

1. INTRODUCTION

WELCOME

Congratulations on your new purchase of the Sport Handheld Label Printer! We've included this User's Guide to help you get printing as soon as possible.

With this guide you will learn how to set up your handheld printer, load supplies, and create custom labels.

The Sport is the best choice in handheld printing. Lightweight and simple to operate, the Sport delivers superior thermal transfer printing performance while conveniently fitting in the palm of your hand. With the soft key menu system, navigating between menu options and adding custom text and graphic images to your labels is now easier than ever.

The Sport allows you to print labels in the field without having to do any data entry on a PC, increasing your label production. The Sport also saves up to 32 label designs for quick retrieval during future labeling tasks.

Please contact us for all your labeling needs. From standardized labels to custom labels, we're ready to provide the labeling supplies you need. Call HellermannTyton at **1-800-537-1512** today to get your labeling problems solved.

SAFETY PRECAUTIONS

- Read all instructions carefully.
- Do not immerse the *printer* or the battery charger in water or other liquids; you could receive an electrical shock.
- Do not expose to high temperatures or high humidity. Never leave on the dashboard or in the trunk of a car.
- Do not use in very dusty places and avoid direct exposure to sunlight and rain.
- Do not remove *hand strap*; it cannot be reinstalled without reassembly of unit.
- Do not attempt to repair the *printer* or the *battery charger*. There are no serviceable parts. If service or repair is needed, contact a qualified HellermannTyton service representative.
- Do not touch the *print head*.
- Use only HellermannTyton certified battery pack and charger.

DEVICE SPECIFICATIONS

Output Device	• 203 dpi Thermal Transfer Print Head
Power	• 7.2 VDC 2000mAh Ni-MH • 100-240VAC wall mounting pack for recharging
Display	• 2.62" x 1.31" (256 x 128 pixels) LCD shows 5 lines
Operating Temp	• +40° F to +122° F (+5° C to +50° C) non-condensating • Condensation can form on any electronic device if transferred from a cold to hot or hot to cold environment quickly. The device will not run until the condensation dissipates.
Storage Temp	• -34° F to +160° F (-30° C to +71° C)
Weight	• 2.7lbs. (1.22kg)

2. GETTING STARTED

UNPACKING & INSPECTION

The Sport has been specially packaged to withstand damage that may occur during the shipping process. However, upon receiving the *printer*, carefully inspect the package and the device. In case of damage, contact the carrier directly to specify the nature and extent of the damage. Please retain the packaging materials in case the *printer* needs to be reshipped.

EQUIPMENT CHECKLIST



If any equipment is missing, please contact HellermannTyton customer service at 1-800-537-1512.

3. The BATTERY

CHARGING THE BATTERY

IMPORTANT: For optimal performance the battery must be charged before use.

LED STATUS

On..... Charging
 Blinking every 2 seconds..... Fully Charged
 Blinking every 1/2 second..... Error

BATTERY



1. Pull up and out on the end of the rubber *battery compartment flap* on the bottom of the printer to open the *battery compartment*.



2. Slide the *battery* into the *printer* until it snaps into place.



3. Close the *battery*

Power Jack

Battery Charge

3. The BATTERY

REMOVING THE BATTERY

IMPORTANT: Always power down the printer before removing the battery to prevent damage to the LCD.



USING THE BATTERY

The Sport has an intelligent battery voltage monitor. As the voltage drops, the firmware drives the battery harder to deliver the voltage needed to maintain high print quality—even as the battery becomes completely discharged. Printed labels maintain the same high quality right up until the battery is completely exhausted.

Printing large characters and/or large labels requires more power than small ones and will drain the battery faster.

Battery usage is monitored by the printer internally to maximize battery life. If the printer is on and not in use after approximately 15 minutes, the printer saves the current label design and powers off to preserve the battery. When the printer is turned on again, the printer will resume from the same screen as when it powered off.



WARNING: Risk of fire or explosion if the battery is replaced by an incorrect type. Use only a HellermannTyton approved battery.

4. LOADING PRINTER SUPPLIES

INSTALLING THE RIBBON CARTRIDGE

IMPORTANT: The printer should be off prior to installing the ribbon cartridge.

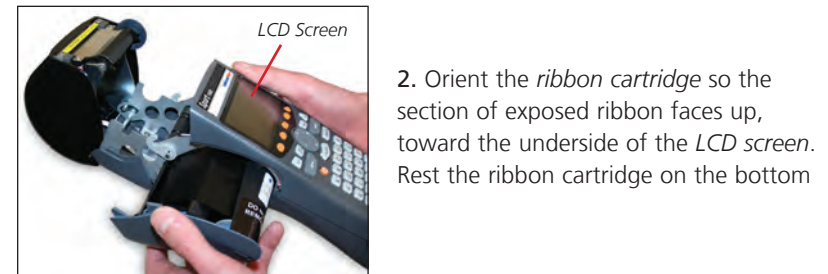
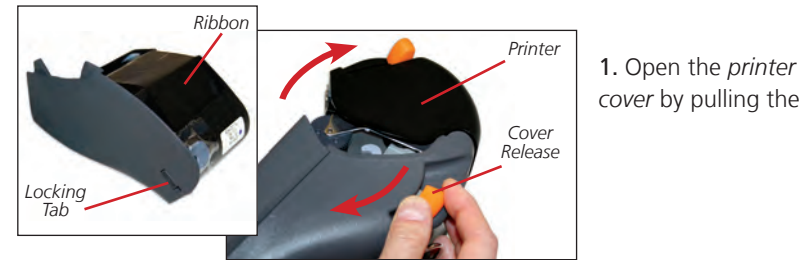

3. Lift the ribbon cartridge slightly to avoid snagging the ribbon on the parts below. Gently slide the ribbon cartridge into the side of the printer until it snaps tightly and is flush with

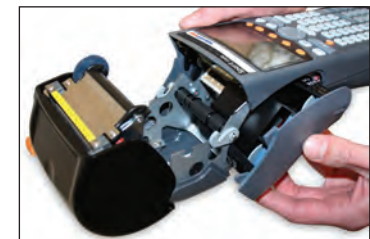

5. Lock the ribbon cartridge in place by



6. Turn the printer on and press **FEED** to tighten the ribbon.

4. LOADING PRINTER SUPPLIES

LOADING THE SUPPLY SPINDLE

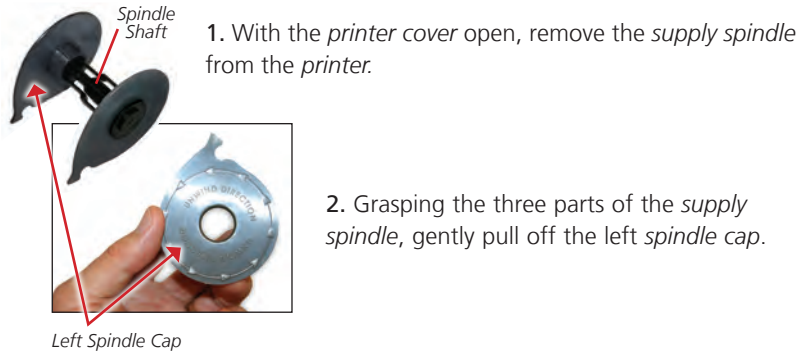

3. Slide the supply over the *spindle shaft* making sure it unwinds in the direction indicated by the arrows on each side of the *supply spindle*.

When using supply that is less than 2" in width, make sure to set the right *spindle cap* in the appropriate notch on the *supply spindle*.

Right Spindle Cap Set for 1" Supply



Supply Spindle With 2" Supply

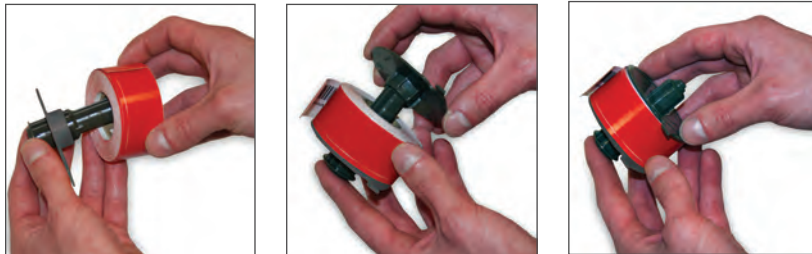

Loading 1" Supply Onto Supply Spindle

LOADING THE SUPPLY SPINDLE cont.



4. Replace the *left spindle cap* on the end of the *spindle shaft* by pressing the caps together until they touch the supply roll, making sure the *spindle hooks* are aligned.

4. LOADING PRINTER SUPPLIES

INSTALLING THE SUPPLY SPINDLE IN THE PRINTER

IMPORTANT: The printer should be off prior to installing the supply spindle.

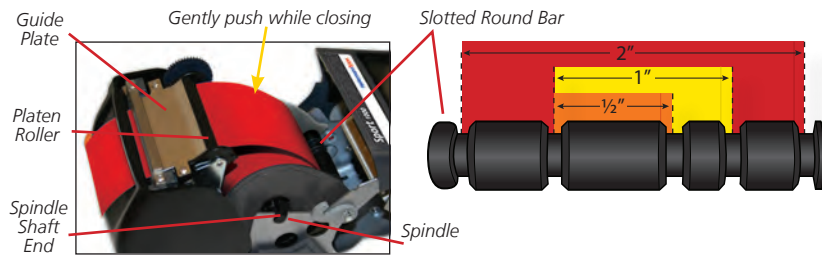

1. To secure the supply, place the *spindle hooks* in the corresponding slots on the *slotted round bar*, as seen in the diagram above.



2. Press the *spindle shaft ends* into the *spindle slots*. Be sure the supply spindle is fully seated.

3. Insert the end of the supply between the *platen roller* and the black strip of the *guide plate*, pushing it through the slot at the top of the *printer cover*.



Drive Gear - turn to manually advance supply



4. Carefully close the *printer cover* without pinching the supply inside, and lock it in place with the *cover release lever*.



Cover Release Lever

NOTE: Once the *printer cover* is closed and the printer is turned on, the *printer* determines the width of the supply, and the supply is aligned for printing labels.



Your Sport printer is now fully loaded and ready to power on. Press the power key  to get started!

5. The PRINTER INTERFACE

The printer interface image below highlights the main navigational tools needed



6. MAKING LABELS

To introduce the process of making labels, it is necessary to understand the different keys found on the printer's interface and the unique screens with which the user frequently interacts.

KEYS

The Sport contains 63 keys used for easy menu navigation, label design, and printer operation.

Soft Keys

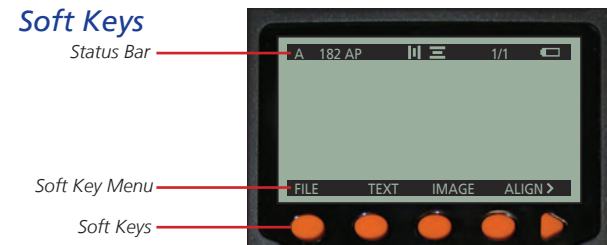

Five soft keys are located just below the LCD screen. The function for each soft key appears on the soft key menu bar above each soft key. This allows the user to navigate between menu options when designing labels or adjusting printer settings.

Keypad

The keypad consists of all keys located below the soft keys. Keys on the keypad generally serve one basic function, unless the **FUNC** key is pressed prior to entering a letter or number on the keypad. Pressing the **FUNC** key activates the red key set on the keypad. The arrow on the far left side of the status bar indicates red key set is active (see page 14).



6. MAKING LABELS

Pressing the power key  turns the *printer* on and off.

The direction pad  is used for screen navigation and cursor placement.

Pressing **MENU** on the key pad will return user to the soft key main menu from any screen. The soft key main menu looks like this:



Pressing **ESC** on the key pad will return to the previous soft key menu.

SCREENS

The Sport has three design screens to aid in designing labels: the *edit screen*, the *size screen*, and the *image screen*. Two other screens, used most commonly when a label design is complete, may also be utilized: the *preview screen*, and the *save screen*.

Edit Screen



The edit screen consists of a status bar, a label layout area, and a soft key menu.









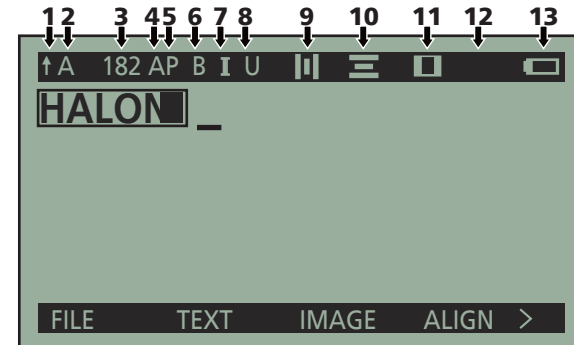















Text and images are entered and modified on this screen. The edit screen displays the layout of the text and images in the label design. Pressing **PREVIEW** displays a representation of the label text and images scaled to actual print size.

► **NOTE:** For further information on what is included on the edit screen, see the [Edit Screen Guide](#) on page 14.

Edit Screen Guide

See the explanation of the numbered items below the image.



1. Red key definitions active 
2. CAPS lock 
A (on) a (off)
3. Size  
4. Auto-size   
5. Unit   
P (point size) % (percent of label)
" (height in inches) M (height in millimeters)
6. Bold  
7. Italic  
8. Underline  
9. Vertical alignment  
|I| (top) |I| (center) |I| (bottom)
10. Horizontal alignment  
≡ (left) ≡ (center) ≡ (right)
11. Border  
 (thin)  (wide)
12. Line number over label line count
13. Battery life indicator



6. MAKING LABELS

Size Screen

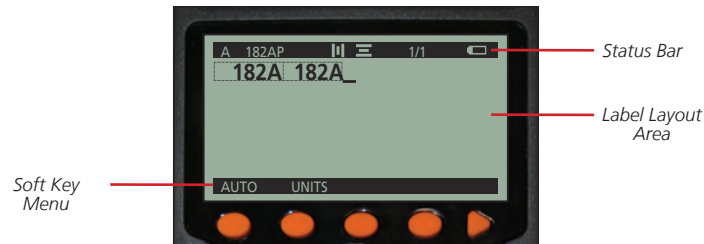

The size screen is accessed through the soft key main menu by pressing the **TEXT** soft key followed by the **SIZE** soft key. Like the edit screen, the size screen consists of a status bar, a label layout area, and a soft key menu.

In the example above, the size is 182 points, the default for 2" supply. The label layout area has two sections: one for the text and one for the image.

While on the size screen, users modify the size of a specific string of characters or images and can adjust the unit of measurement for the label design. Pressing the **AUTO** soft key on the soft key menu allows the user to enable and disable the auto-size setting for a specific string of characters or images (to learn about the auto-size feature, see [TEXT/IMAGE AUTO-SIZE](#) on page 17). Pressing **UNITS** allows the user to change the unit of measurement for the label design to one of the following: POINT, PERCENT, INCHES, or MM.

To return to the edit screen from the size screen, press **MENU**.

► **NOTE:** For information on label design using the size screen, see [CELLS](#) on page 18.

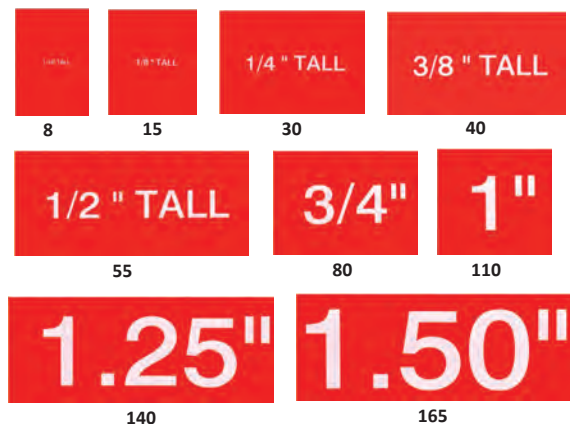
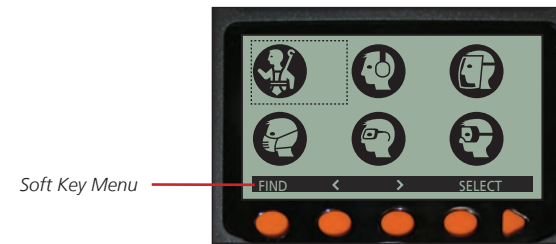

Image Screen



The image screen is accessed through the main menu by pressing the **IMAGE** soft key. The image screen displays graphic images found in the Sport Image Library. Browse the Image Library using the direction pad or by pressing the options as seen in the soft key menu.

► **NOTE:** For information on inserting images, see [APPLYING GRAPHIC IMAGES TO LABELS](#) on page 22.

Preview Screen



The preview screen is accessed by pressing **PREVIEW** on the key pad. The preview screen displays a representation of how a label will appear when printed, showing text and images scaled to actual size. Scroll through label parts using the direction pad.

► **NOTE:** For information on previewing label designs, see [PREVIEWING & PRINTING LABELS](#) on page 26.

6. MAKING LABELS

Save Screen



The save screen is accessed through the main menu by pressing the **FILE** soft key. The save screen lists the label designs stored on the printer. The soft keys allow the user to save the current label design, open previously saved label designs, and delete label designs.

TEXT/IMAGE AUTO-SIZE

Auto-size automatically adjusts the size of the text and images to fill the entire label area (whether the label consists of one line or many lines). Auto-size enabled is the printer's default setting.

Individual text characters, groups of text characters, and images may have auto-size enabled or disabled, even if they are located within the same line. Auto-size is denoted by an "A" immediately to the right of the number indicating the current text or image size in the status bar on the edit screen and the size screen (see pages 13 and 14).



The "A" also appears on the size screen in the label layout area (see size screen image on page 15).

► **NOTE:** Do not get this "A" confused with the "A" that represents CAPS lock on, which is on the far left side of the status bar.

A one line label with auto-size enabled would appear like this:



A two line label with auto-size enabled appears like this:



Auto-size can be disabled by manually changing the size on the size screen.

CELLS

A cell represents text or images that have similar attributes to one another on the same line. A label design may consist of one or many cells.

New cells are created when text attributes within a line are changed. Each image is represented by a single cell. Cells are seen on two screens: the edit screen and the size screen. The following examples illustrate how cells work:

Cells As Seen On the Edit Screen



The first line consists of two cells. The characters of the first cell "JOHN SMITH," share the same attributes: bold, and auto-size. The characters of the second cell, "Receiving Dept.," are italicized and set to size 24 Point.

6. MAKING LABELS

As previously noted, new cells are created when attributes are changed within a line. As seen in this label example, attributes of the words "JOHN SMITH," differ from the attributes of the words "Receiving Dept."



In the label design process, the italics feature was selected while the cursor lay under the letter "R" in "Receiving." This creates a second cell on the first line beginning with the letter "R." Italics now applies to all characters after "R" on the first line until italics is toggled off. In this example, however, no other modifications are made thereafter, so the first line consists of only two cells.



When the cursor is moved throughout the first line on the label design, the status bar reflects the current attributes of each unique cell.



The second line consists of four cells on the edit screen. The first cell consists of the telephone image with auto-size enabled. The second cell begins at the first "5" in the phone number because auto-size has been disabled and a text size was manually entered on the size screen. The third cell begins at the "e" of "ext." because the text size was reduced, and the fourth cell begins at the number "1" because the text size of "122" was enlarged again.



When the cursor is moved throughout the second line on the label design, the status bar reflects the current attributes of each unique cell.



Cells As Seen On the Size Screen

Navigate from the edit screen to the size screen..... **TEXT** **SIZE**

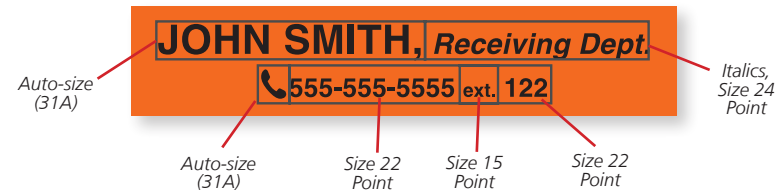

The label design as seen on the size screen appears like this:



When the cursor is moved between cells in a label design, as shown above, the status bar reflects the attributes of each cell on the line.

CHANGING TEXT/IMAGE SIZE MANUALLY

1. From main menu **MENU**
2. Change the text/image size manually **TEXT** **SIZE**
3. Move the cursor to the cell where the change is desired.
- ▶ **NOTE:** Changes will also appear on the edit screen.
4. To change unit of measurement..... **POINT** or **PERCENT** or
..... **INCHES** or **MM**
5. Enter the size of the text/image for each cell **SIZE** 20
▶ **NOTE:** Changing the size manually disables auto-size ("A" is removed from status bar).
- 6a. Apply the text/image size change to the label design and remain on the size screen **ENTER**
- or
- 6b. Apply the text/image size change to the label design and return to the edit screen..... **MENU**

6. MAKING LABELS

MODIFYING TEXT STYLE ATTRIBUTES

Bold, Italics, and Underline

1. From the main menu **MENU**
2. Move the cursor underneath the first character to be modified 
3. Modify the text style attributes **TEXT**
- 4a. Enable or disable the bold style **BOLD**
- 4b. Enable or disable the italics style **ITALICS**
- 4c. Enable or disable the underline style **UNDER**

► **NOTE:** An enabled text style attribute is denoted by a "■" to the style name's right on the soft key menu, and depending on the text style(s) enabled, a "B," "I," or "U" appears on the status bar.

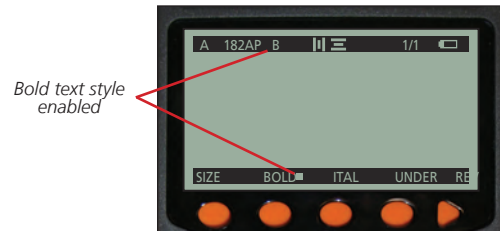

► **NOTE:** Once enabled, the text style attribute applies to the modified text character and subsequent characters until the text style is changed again.

Uppercase and Lowercase

Pressing **CAPS** toggles text between uppercase and lowercase letters. A capital "A" appears on the far left side of the status bar, indicating CAPS lock is on, and characters typed on the *keypad* appear uppercase. CAPS lock on is the printer default. A lowercase "a" indicates CAPS lock is off, and characters typed on the *keypad* appear lowercase.



Status bar showing CAPS lock indicator on left side.

Line Justification



The align feature applies the selected horizontal or vertical alignment to the label. The default horizontal alignment is center. The default vertical alignment is center.

Modify the line justification for a label:

1. From the main menu **MENU**
2. Select the alignment **ALIGN**
3. Modify the horizontal alignment. **HORIZONTAL** **LEFT** or **CENTER** or **RIGHT**
4. Select the vertical alignment **VERTICAL** **TOP** or **CENTER** or **BOTTOM**

APPLYING GRAPHIC IMAGES TO LABELS

Images found in the Image Library (pgs 23-24) are preinstalled on the Sport.

1. From the main menu **MENU**
2. On the edit screen, place the cursor in the desired location in the label layout area 
3. Do one of the following:
 - a) Insert an image **IMAGE**  **ENTER**
 - b) Insert an image **IMAGE** **<** **>** **SELECT**
 - c) Insert an image **IMAGE** **FIND** 001-250 **SELECT**

► **NOTE:** On the edit screen, a graphic image will appear as a black place holder (■).

6. MAKING LABELS

THE IMAGE LIBRARY

1	2	3	4	5	6	7	8	9	10
11	12	13	14	15	16	17	18	19	20
21	22	23	24	25	26	27	28	29	30
31	32	33	34	35	36	37	38	39	40
41	42	43	44	45	46	47	48	49	50
51	52	53	54	55	56	57	58	59	60
61	62	63	64	65	66	67	68	69	70
71	72	73	74	75	76	77	78	79	80
81	82	83	84	85	86	87	88	89	90
91	92	93	94	95	96	97	98	99	100
101	102	103	104	105	106	107	108	109	110
111	112	113	114	115	116	117	118	119	120
121	122	123	124	125	126	127	128	129	130

131	132	133	134	135	136	137	138	139	140
141	142	143	144	145	146	147	148	149	150
151	152	153	154	155	156	157	158	159	160
161	162	163	164	165	166	167	168	169	170
171	172	173	174	175	176	177	178	179	180
181	182	183	184	185	186	187	188	189	190
191	192	193	194	195	196	197	198	199	200
201	202	203	204	205	206	207	208	209	210
211	212	213	214	215	216	217	218	219	220
221	222	223	224	225	226	227	228	229	230
231	232	233	234	235	236	237	238	239	240
241	242	243	244	245	246	247	248	249	250

6. MAKING LABELS

CREATING BARCODES

Barcodes may be printed on labels using Code 39 symbology. Barcodes can be created above, below, or on either side of text during the label design process.

1. From the main menu **MENU**
2. On the edit screen, position the cursor where you want the barcode to appear.
3. Create barcode cell **> BAR**
4. With the cursor positioned within the barcode cell on the right side, type the desired barcode characters.

► **NOTE:** Moving the cursor to the left side within the barcode cell and typing with the keypad positions characters outside of the barcode (i.e., characters appear separate from and to the left of the barcode). Text entered from this position does not translate into printed barcode characters.



The following character sets are allowable in Code 39 symbology:

- | | |
|---------------------------------|-------------------------|
| Numerals (0-9) | Uppercase letters (A-Z) |
| Special characters (. / + - \$) | Blank spaces |

► **NOTE:** Entering characters other than those in the allowable character sets will print but will not be read by a barcode scanner.

ADDING A BORDER

Place a border around the entire contents of a label.

WATCH YOUR STEP

1. From the main menu **MENU**
2. Add a border **> BAR THIN** or **WIDE**

► **NOTE:** A thin border is approximately 0.5 mm wide. A wide border is approximately 1 mm wide.

PREVIEWING & PRINTING LABELS

Pressing **PREVIEW** from any screen displays a representation of the label design as it appears when printed. The preview screen shows text and images to actual size. Use the arrows on the direction pad to view other parts of the label design.

Press **PRINT** to print your label or **MENU** to go back and edit your label design. When the label is finished printing, pull down on the red *cutter lever* to cut the label. The label roll is set, and the *printer* is ready to print the next label. To cancel the print job at any time, press **ESC**.

► **NOTE:** If the printer's auto-feed setting is off (see page 31), it is necessary to first press **FEED** to feed the remaining printed portion of the label from the printer prior to cutting the label.

DELETING CURRENT LABELS

1. Delete a current label and clear the edit screen **FUNC DEL**
- **NOTE:** **FUNC** activates the red key definitions (see page 12), in this case. **DEL ALL**.
2. When the message "Delete label?" appears **DELETE**
- **NOTE:** To leave the current screen without deleting the current label design, press **MENU**.



SAVING LABELS

A label design remains on the edit screen until it is saved or deleted, even if the printer is turned off and back on. When replacing a label design with a new design, the printer prompts the user to name the label design to be saved.

1. Return to the main menu **MENU**
2. Go to the save screen **FILE**
3. Save the label **NEW SAVE**
4. Type the label name HALON -26-

6. MAKING LABELS



5. Accept the file name..... **ENTER**

The label is now saved, and the user is returned to the default edit screen to begin a new label.

► **NOTE:** Up to 32 labels can be stored in the printer at one time.

DELETING SAVED LABELS

1. From the main menu..... **MENU**

2. Go to save screen..... **FILE**

3. Select the label to be deleted..... 

4a. Delete the label..... **DELETE**

or

4b. Delete all saved labels..... **DEL ALL**



5. Return to the main menu..... **MENU**

OPENING SAVED LABELS

1. From the main menu..... **MENU**

2. Go to the save screen..... **FILE**



3. Select the label to open..... 

4. Open the label..... **OPEN**

7. PRINTER SYSTEM SETTINGS

OPTIMIZING PERFORMANCE & QUALITY

The Sport allows users to adjust system settings for optimal printer performance and print quality. System settings including display screen contrast, print head temperature, motor speed, auto-feed, test printing and system reset are accessed from the soft key main menu:

1. From the main menu **MENU** >
2. Go to the system settings..... **SYSTEM**



DISP (Display)

On this screen, the user may decrease or increase the contrast level of the LCD screen—making it brighter or darker—by pressing the **<** and **>** soft keys.



PRINT

This soft key directs users to another series of soft key options related to printing:

- From Main Menu
- Press > Softkey
- Press System
- Press Print

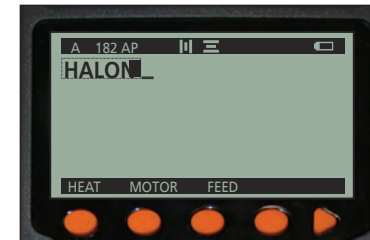

Print head heat settings, motor speed settings, and auto-feed settings are adjusted here.

Heat

Print head heat may be decreased or increased by pressing the **DEC** and **INC** soft keys or by using the direction pad .



This setting is useful when printed characters appear spotty, blurred, uneven, too dense or faint. Increasing heat causes printed characters to appear darker and denser. Too much heat, however, can cause an undesirable pattern to appear or may even burn through the ribbon. Adjust the temperature to achieve optimal print quality.



7. PRINTER SYSTEM SETTINGS

► **NOTE:** See [Test](#) on page 32.

Printing on a lower heat setting uses less battery power and allows the printer to print labels at a faster rate.

Motor

Motor speed (how fast or slowly the motor feeds the label past the print head) may be decreased or increased by pressing the **DEC** and **INC** soft keys or by using the direction pad.



Feed

When auto-feed is on, the label is automatically advanced past the cutter position after printing is completed. When auto-feed is off, the user must press **FEED** to advance the label after printing is completed.



Disabling auto-feed is useful when designing labels that merge or split lines (see label example on page 36).

The auto-feed setting may be enabled or disabled with the **FEED** soft key.

► **NOTE:** "■" denotes that auto-feed is

TEST

This soft key directs users to another series of soft key options related to testing printer performance.



Feed

The printer's feed feature may be tested by pressing the **FORWARD** and **BI-DIR** (bi-directional) soft keys. Loaded supply feeds from the printer.



Test

This soft key tests print head heat settings by printing heat test results onto the supply. The user may verify which setting yields the best print results and apply that heat setting to a label print job. See [Heat](#) on page 30.



Heat test results label

7. PRINTER SYSTEM SETTINGS

Print Ver

This soft key prints printer version information and current motor and heat settings onto supply.



RESET





This soft key “reboots” the printer and restores the printer’s default settings. This option is particularly useful if the printer begins functioning out-of-character and the printer needs to be restored to its original settings. This screen appears during the system reset process:



► **NOTE:** Saved labels are not erased during reset.

HARD RESET

A hard reset may be performed to return the printer to a known state if it is functioning “out of character.” To perform a hard reset,

1. Press and hold the power key..... 
2. While holding down the power button, press down the ESC key .. 
3. Continue to hold the ESC key but release the power button..... 
4. Release the ESC key..... 

Example Label Directions #1: PIPE MARKER









Finished Label



Red 2" Premium Vinyl Tape and White Ribbon Cartridge

This label's features and settings:

Two lines of text, one image	Auto-feed: enabled
Unit of measurement: POINT	CAPS Lock: ON
Auto-size: enabled (1st line)	
Label text style: BOLD (1st line)	

1. From the main menu 
2. Enable bold setting.....  
- **NOTE:** When enabled, a small box appears to the right of the menu option.
3. Type the label text..... HALON
4. Return to the main menu 
5. Insert an image.....   
- **NOTE:** The image appears on the edit screen as a black place-holder.



8. EXAMPLE LABELS

6. Advance to the next line..... **ENTER**
7. Disable the bold setting **TEXT BOLD**
8. Change the text size to 30 pt **SIZE 30**
- ▶ **NOTE:** The auto-size indicator "A" disappears when the size is manually entered.
9. Return to the edit screen **MENU**
10. Type the label text FIRE SYSTEM 7A
11. Preview the label **PREVIEW** 



12. Print the label..... **PRINT**

▶ **NOTE:** After printing, cut the label by pulling the red *cutter lever* down.



Example Label Directions #2: OSHA SAFETY LABEL



Finished Label



Yellow 2" Vinyl Tape and Black Ribbon Cartridge

This label's features and settings:

Three lines of text, one image

Auto-feed: **disabled**

Unit of measurement: **POINT**

CAPS Lock: **ON**

Auto-size: **disabled (first label design)**

Label alignment: **HORIZONTAL - LEFT** and **VERTICAL - CENTER.**

This label is created using two separate label designs. Creating the label with two designs allows the user to merge or split lines. In this example, three lines of text are merged into one line containing an image. The auto-feed setting must be disabled for the image to print directly next to the text portion of the

FIRST LABEL DESIGN

Disable Auto-Feed

1. From the main menu **MENU** 
2. Go to the system settings..... **SYSTEM**



8. EXAMPLE LABELS

3. Go to the print settings..... **PRINT**

4. If auto-feed is enabled, press **FEED**

► **NOTE:** “■” denotes that auto-feed is enabled

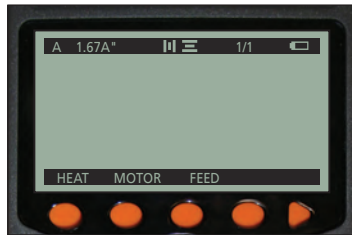

5. Return to the main menu..... **MENU**

Left Justify Text

5. Select the alignment..... **ALIGN**

6. Modify horizontal alignment..... **HORIZONTAL LEFT**

Enable Bold Style

7. Enable the bold style..... **TEXT BOLD**

► **NOTE:** “■” denotes the text style is enabled



8. Type the label text SAFETY

9. Advance to the next line **ENTER**



10. Type the label text GLASSES

11. Advance to the next line **ENTER**

Enable Bold Style

12. Enable the underline style **UNDER**

13. Type the label text REQUIRED



14. Print the label **PRINT**

The entire “SAFETY GLASSES REQUIRED” portion of the label will print. Do not press **FEED**. The label is now in position to print the second label design (safety glasses image) right next to the “SAFETY GLASSES REQUIRED” portion of the label. Proceed to the steps below for the second label design.

SECOND LABEL DESIGN

To create the second label design, begin by saving or deleting the current “SAFETY GLASSES REQUIRED” label design.

Save or Delete Current Label

1. Go to the save screen **FILE**

2a. Save the current label **NEW SAVE**

Type the desired label name SAFETY GLASSES

Save the current label **SAVE**

A new edit screen appears.

or

2b. Delete the current label **NEW DELETE**

A new edit screen appears.

8. EXAMPLE LABELS

With a new edit screen, the second label design—consisting of the safety glasses image—can now be created.

Insert Image

3a. Insert the image..... **IMAGE**  or **<** **>** **ENTER**

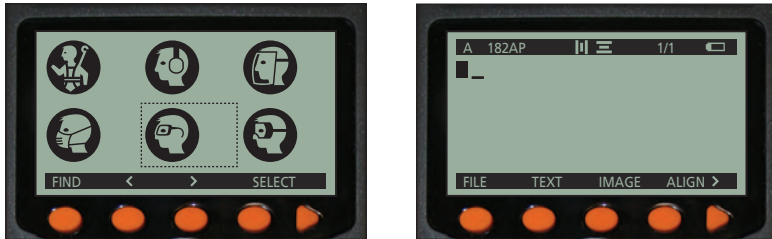

or

3b. Insert the image..... **IMAGE** **FIND**

Refer to the Image Library (pages 23 & 24).

Select the image number..... 197 **ENTER** or **SELECT**



► **NOTE:** The image appears on the edit screen as a black placeholder box.

4. Print the label **PRINT**

5. Feed the label **FEED**

Example Label Directions #4: BARCODE



Finished Label



White 1/2" Premium Vinyl Tape
and Black Ribbon Cartridge

This label's features and settings:

One line of barcode, one line of text

Auto-feed: **ON**

Unit of measurement: **POINT**

CAPS Lock: **ON**

Auto-size: **enabled** (first line) and **disabled** (second line)

Label alignment: **HORIZONTAL - CENTER, VERTICAL - TOP.**

Set Vertical Alignment

1. From the main menu **MENU**

2. Align the label vertically at the top..... **ALIGN** **VERTICAL**



8. EXAMPLE LABELS

Set Vertical Alignment

1. From the main menu **MENU**
2. Align the label vertically at the top **ALIGN VERTICAL TOP**

Insert Barcode

3. Insert the barcode **BAR**

The barcode symbol appears on the edit screen:



4. Type the barcode data SRE091753



Enter Label Text

5. From the main menu **MENU**
6. Advance to the next line **ENTER**
7. Change the text size to 10 point **TEXT SIZE 10**
8. Register the text modification **ENTER**

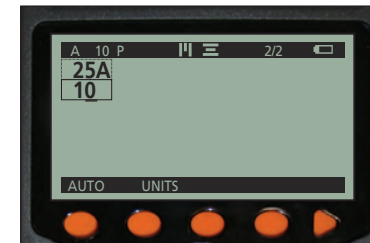

► **NOTE:** The auto-size indicator "A" is removed for the second line when the text is manually entered.

9. Return to the main menu **MENU**
10. Type the label text SRE091753



11. Print the barcode label **PRINT**

9. CLEANING & MAINTENANCE



IMPORTANT:

Always turn OFF printer before cleaning or performing other maintenance.

The Sport requires no lubrication and only minimal maintenance. Basic cleaning of the exterior, the *print head* and the *platen roller* will prolong the life of the *printer* and aid in producing crisp, clear labels with every print.

CLEANING EXTERIOR SURFACES

Use a damp cloth moistened with water and mild detergent solution, or use commercial cleaner designed for electronic equipment, and wipe off any dust, dirt or other visible markings.

CLEANING THE PRINT HEAD

1. Turn off the *printer*.
2. Open the *printer cover* by pulling down on the *cover release lever*.
3. Remove the *supply spindle* and *ribbon cartridge* to expose the *print head*. Do not touch the *print head* with fingers or other objects.
- 4a. Using a cleaning pen, lightly place the tip of the pen onto the *print head*, and rub back and forth several times to pull up any ribbon and ink particles. Repeat this process if necessary.
- 4b. Using a cleaning card, insert one end of the card between the *platen roller* and the *black strip* of the *guideplate*, pushing it through the slot at the top of the *printer cover*. Place the other end of the card over the *slotted round bar* and down into the compartment space so that the card lies between the *slotted round bar* and the *print head*. Close the *printer cover*, turn the *printer* on, and press  .
- 4c. If no cleaning pen is available, the *print head* may be cleaned using a cotton swab wetted with isopropyl alcohol in the same manner as described in step 4a.
5. Allow the alcohol to dry, then replace the *ribbon cartridge* and the loaded *supply spindle*. Repeat as needed, or after every four or five rolls of supply.

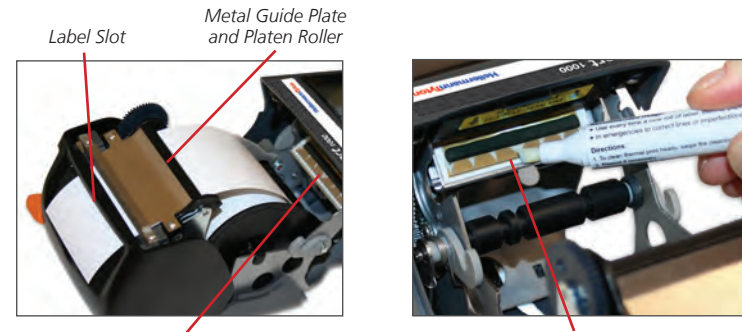

CLEANING THE PLATEN ROLLER

1. Turn off the *printer*.
2. Open the *printer cover* by pulling down on the *cover release lever*.
3. Remove *supply spindle* and *ribbon cartridge* to prevent cleaning solutions from running on them. Be careful not to touch the *print head* with fingers or other objects.
4. Using a cotton swab wetted with isopropyl alcohol, place the tip of the swab onto the *platen roller*, and rub back and forth several times. Rotate the *platen roller wheel* to expose other areas on the *platen roller*, and repeat the cleaning process.
5. Allow the alcohol to dry, then replace the *ribbon cartridge* and loaded *supply spindle*. Repeat as needed, or after every four or five rolls of supply.



10. COMPLIANCE & WARRANTY

FCC NOTICE

This equipment has been tested and found to comply with the limits for a Class A digital device, pursuant to Part 15 of the FCC Rules. These limits are designed to provide reasonable protection against harmful interference during installation. This equipment generates, uses and can radiate radio frequency energy and, if not installed and used in accordance with the instructions, may cause harmful interference to radio communications. However, there is no guarantee that interference will not occur in a particular installation. If this equipment does cause harmful interference to radio or television reception, which can be determined by turning the equipment off and on, the user is encouraged to try to correct the interference by one or more of the following measures:

- Reorient or relocate the receiving antenna.
- Increase the separation between the equipment and receiver.
- Connect the equipment to an outlet on a circuit different from that to which the receiver is connected.
- Consult the dealer or an experienced radio/television technician for help.

Modifications made to the *printer* that are not approved by HellermannTyton, Inc. could be in violation of FCC regulations and void the user's authority to operate the equipment.

WARRANTY

HellermannTyton warrants to the customer that under normal use and service the printer (with the exception of the print head) purchased, hereunder shall be free from defects in material and workmanship for a period of 90 days, from the date of shipment by HellermannTyton. The user can qualify for a one year warranty by registering the printer on line at www.hellermanntyton.us/warrantyregistration within 14 days of purchase. Expendable items or parts such as labels and ribbons are not covered by this warranty. This warranty does not cover equipment or parts that have been misused, altered, neglected, carelessly handled, or used for purposes other than those for which the printer was manufactured. The warranty also does not cover loss, damages resulting from accident, or damages resulting from unauthorized service.

THERMAL PRINT HEAD

The warranty of the thermal print head is limited to 90 days from the date of shipment to buyer. As stated above; the warranty can be extended to one year if the user registers the printer within 14 days of purchase. The warranty does not cover thermal print heads which have been misused, altered, neglected, handled carelessly, or damaged due to improper cleaning or unauthorized repairs.

WARRANTY SERVICE PROCEDURES

If defects should occur during the warranty period, the defective unit shall be returned, freight and insurance prepaid, in the original shipping container to HellermannTyton, Inc. Include a contact name, action desired, and a description of the problem and examples when possible. HellermannTyton, Inc. shall not be responsible for any loss or damages incurred during shipping. Any warranty repairs to be performed by HellermannTyton, Inc., shall be subject to said company's confirmation that the product meets warranty guidelines in the event of a defect covered by its warranty.

WARRANTY SERVICE PROCEDURES

If defects should occur during the warranty period, call HellermannTyton customer service and request an RGA number for your printer. The defective unit shall be returned, freight and insurance prepaid, in the original shipping container to HellermannTyton with proper RGA number referenced. Include a contact name, action desired, and a description of the problem and examples when possible. HellermannTyton shall not be responsible for any loss or damages incurred during shipping. Any warranty repairs to be performed by HellermannTyton shall be subject to said company's confirmation that the product meets warranty guidelines in the event of a defect covered by its warranty.

GENERAL WARRANTY PROVISIONS

HellermannTyton makes no warranty as to the design, capability, capacity, or suitability of any of its hardware, supplies or software. Software is licensed on an "as is" basis without warranty. Except and to the extent expressly provided in this warranty and in lieu of all other warranties, expressed or implied, including, but not limited to any warranties of merchantability or fitness for a particular product, purchaser shall be solely responsible for the selection, use, efficiency and suitability of HellermannTyton's products.

10. COMPLIANCE & WARRANTY

LIMITATION OF LIABILITY

In no event shall HellermannTyton be liable to purchaser for any indirect, special, or consequential damages or lost profits arising out of or relating to HellermannTytons' products, or of the performance or a breach thereof, even if HellermannTyton has been advised of the possibility thereof.

HellermannTytons' liability, if any, to the purchaser or to the customers of purchaser hereunder shall in no event exceed the total amounts paid to HellermannTyton hereunder by the purchaser for a defective product.

In no event shall HellermannTyton be liable to purchaser for any damages resulting from or related to any failure or delay of HellermannTyton in the delivery or installation of the computer hardware, supplies, or software in the performance of any services. The remedies set forth here are the sole and exclusive remedies available to any person for any damages of any kind and nature including incidental, consequential, or special, whether arising from warranty (including implied warranties), contract, negligence, tort or otherwise. In the event that any implied warranties (including but not limited to the implied warranties of merchantability and fitness for a particular purpose) are found to exist, such warranties are limited in duration to their respective warranty periods.





NOTE:Out of warranty repairs are \$60.00. Customer will pay shipping to HT and HT will pay for shipping back to customer. If the unit sent in is still under its original warranty, then the new warranty is 90 days or to the end of the original warranty, depending on which is longer. The warranties and remedies contained herein are exclusive and in lieu of all other warranties whether expressed, implied or statutory, including any liability arising under any warranty of merchantability or fitness for a particular purpose, statutory or otherwise. This warranty gives the user purchaser specific legal rights, which may vary from state to state.

HellermannTyton retains the exclusive right within all warranty periods to repair the product, replace the product or offer a full refund of the purchase price, at its sole discretion. Such remedy shall be the purchaser's sole and exclusive remedy for any breach of warranty.

11. TROUBLESHOOTING TIPS

SYMPTOMS & SOLUTIONS

Hard Reset - A hard reset may be performed to return the printer to a known state if it is functioning "out of character." To perform a hard reset, first pull out and reinsert the battery and then follow the steps below.

1. Press and hold the power key..... 
2. While holding down the power button, press down the ESC key 
3. Continue to hold the ESC key but release the power button 
4. Release the ESC key..... 

Display Stays Blank/Black When the Printer is Turned ON

- Make sure the *printer* is operating within temperature specifications listed in this manual (page 2).
- If the *printer* has been recently transferred from one temperature environment to another, there may be slight condensation on the circuit board. This will dissipate in approximately 10 minutes. Allow the *printer* to equalize with current room temperature before operating.
- Make sure the *battery* is fully charged and properly installed.
- Perform a hard reset as described above.

Printer Attempts to Print, But Supply Does Not Feed Out of Printer

- Ensure the supply has been loaded properly and is not jammed inside the *printer*.
- Make sure a *ribbon cartridge* is loaded into the *printer* and that the *ribbon cartridge* is not empty.
- Make sure the *supply spindle* is not too tight (the supply should easily feed).
- Clean the *platen roller* as described in the manual.
- Make sure the *battery* is fully charged. A depleted battery might still run the LCD but might not have enough power to print labels.

The Printer Cover Will Not Close

- Ensure the *cover release lever* is in the locked position.
- Make sure the loaded supply is going under the *metal guide plate*.

Printing Appears Uneven in Density and is Spotty or Blurred

- Charge the battery
- Clean the *print head* as described in the manual.
- Increase the heat settings.

11. TROUBLESHOOTING TIPS

Printed Characters Are Not Formed Properly

- Clean the *platen roller*.
- Charge the *battery*.
- Clean the *print head* or adjust print density or motor speed.
- Make sure dust and foreign objects are not on the *platen roller*.

Printer Does Not Recognize Supply

- Make sure only HellermannTyton' supply is loaded in the *printer*.
- Make sure the supply has a barcode on the back of the liner.

Diagonal Lines Appear in Text Due to Ribbon Wrinkle

1. Open the printer cover to see the ribbon. Press  until wrinkles disappear.
2. Remove the *ribbon cartridge*. Tap on the gray portion of the *ribbon cartridge* while the black portion rests on the table.
3. Or, install a new cartridge.

Error Says Lithium Battery is Low - Contact HellermannTyton for replacement options.

There is a Missing Line in the Printout in the Same Location on Every Label

- Clean *print head*
- If line continues this indicates the *print head* pixels have been damaged in this area. The Sport prints in landscape mode, so the missing line shows up throughout the entire label. Contact HellermannTyton.

Printer Makes a Grinding Noise When Attempting to Print

The *printer* makes noise during normal operation. If the noise is out of character the clutch might need readjustment at the factory or might need to be replaced.

Faint Lines Appear On the Display

This primarily results in stress to the LCD and is caused by removing the *battery* while the power is still ON. Always remove the *battery* when the power is OFF. Lines should disappear within a few days.

ERROR MESSAGES	MEANING
Storage is full	The printer has reached the limit of possible saved labels. To create space, delete unused labels as explained in "Deleting Current Labels" section of this guide.
Value too large	No more room exists to add the desired character to the label.
Not compatible with current stock	The unit knows which supply is currently loaded in the printer. If you try to retrieve a saved label that was saved using a different supply size, this error will alert you so that you cannot retrieve that label until the proper size supply is loaded in the printer.
Label design was not stored	The label design was not stored due to the memory being full or due to a canceled save.
Please close the cover	You must close the printer cover before printing.
Out of memory	You have reached the maximum number of lines to a label.
Load label stock	The supply is not loaded in the printer, or the printer cannot read the barcode on the back of the supply.

12. SOFT KEY MENU SYSTEM

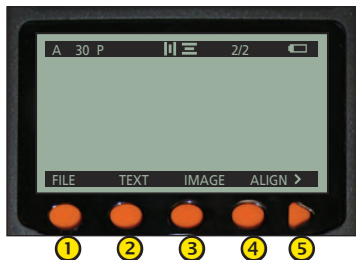

This tree-diagram shows the flow of menu choices within the soft key menu system and includes a brief description of each choice.

The **ESC** key returns the user to the previous menu or screen.

Soft Key ①

FILE – go to the save screen

NEW – begin new label design; return to default edit screen and soft key main menu

SAVE – save current label and return to the edit screen and soft key main menu

SAVE – save file name as entered and return to edit screen and soft key main menu

DELETE – delete current label and return to the edit screen and soft key main menu

OPEN – open selected, previously saved label for further editing or printing

DELETE – delete selected label

DELETE – delete selected label and return to edit screen and soft key main menu

DEL ALL – delete all previously saved labels on the save screen

DELETE – confirm deletion of all previously saved labels on the save screen

Soft Key ②

TEXT – change text style attributes

SIZE – change text size

AUTO – enable/disable auto-size setting

UNITS – select unit of measurement (POINT, PERCENT, INCHES, MM) for each cell

POINT – format label using Point

PERCENT – format label using Percent

INCHES – format label using Inches

MM – format label using Millimeters

BOLD – toggle between bold and plain text style

ITAL – toggle between italics and plain text style

UNDER – toggle between underlined and plain text style

REV – reverse text/image and background color

Soft Key ③

IMAGE – select an image to include on label

FIND – enter the number associated with an image within the image library

SELECT – jump to the selected image on the image screen

< – return to previous page of images on the image screen

> – advance to next page of images on the image screen

SELECT – select highlighted image and return to edit screen and soft key main menu

Soft Key ④

ALIGN – change alignment of label

HORIZONTAL – align text/image(s) horizontally on label

LEFT – align text/image(s) on left side of label

CENTER – align text/image(s) in center of label

RIGHT – align text/image(s) on right side of label

VERTICAL – align text/image(s) vertically on label

TOP – align text/image(s) at top of label

CENTER – align text/image(s) in center of label

BOTTOM – align text/image(s) at bottom of label

Soft Key ⑤

> – scroll to next soft key menu option (the BAR and SYSTEM soft keys)

BAR – create new cell on edit screen to input barcode data

BORDER – place border around text/image(s)

THIN – place thin border around text/image(s)

THICK – place thick border around text/image(s)

SYSTEM – enter system settings menu

DISP – view the current contrast setting for the LCD screen

< – increase the contrast of the LCD

> – decrease the contrast of the LCD

PRINT – adjust print settings

HEAT – adjust the heat of the print head

DEC – decrease the heat of the print head

INC – increase the heat of the print head

MOTOR – adjust advancement speed of label

DEC – decrease motor speed

INC – increase motor speed

FEED – adjust printer's auto-feed setting

TEST – verify printer is performing correctly

FEED – used for diagnostic purposes only

FORWARD – feeds supply forward

BI-DIR – feeds supply forward and then backward

TEST – print a test label showing print head heat results

PRINT VER – print a copy of printer info (serial, version, and

motor and heat settings) onto loaded supply

RESET – restore printer default settings

13. ACCESSORIES & SUPPLIES

NOTES

To get the most out of your *Sport*, optional accessories may be ordered upon request. Contact HellermannTyton:
1-800-537-1512 • www.hellermann.tyton.com



Sport Soft Case
591-00263



Sport Hard Case
557-00002



Supply Spindle
591-00231



Rechargeable Battery
557-00003



Ribbon Cartridge - in white (591-00233) and black (591-00232).



Battery Charger
591-00076



Premium Vinyl Tape - 1/2", 1" and 2" rolls in white and red.

HellermannTyton

North American Headquarters
TS16949, ISO 9001 and ISO 14001 Certified
7930 North Faulkner Road
PO Box 245017
Milwaukee, Wisconsin 53224

phone: 800.537.1512
fax: 800.848.9866
email: corp@htamericas.com
web: www.hellermann.tyton.com